

For Sale

± 6.05 Acres



NEC Primrose Drive @ U.S. Highway 287 Bypass Midlothian, Texas 76065

Property Features

- U.S. Highway 287 Bypass Frontage
- 33,000+ Vehicles Per Day
- Growing Ellis County Community
- Sale Price: \$2,240,000.00

Tom Heraty

214 256 7175
theraty@nairl.com

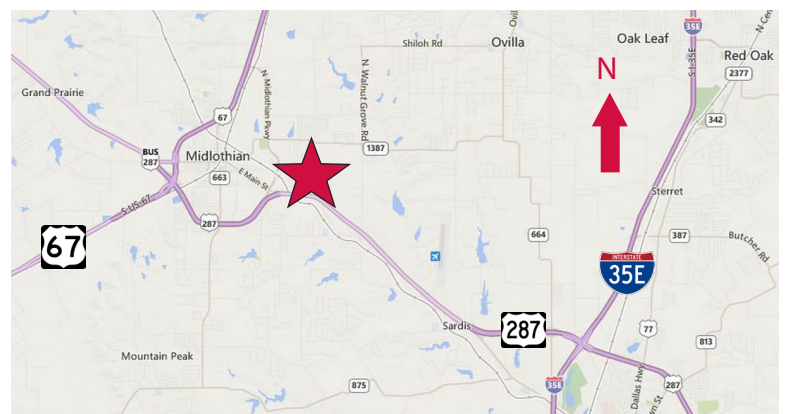

THE INFORMATION CONTAINED HEREIN HAS BEEN GIVEN TO US BY THE OWNER OF THE PROPERTY OR OTHER SOURCES WE DEEM RELIABLE. WE HAVE NO REASON TO DOUBT ITS ACCURACY, BUT WE DO NOT GUARANTEE IT. ALL INFORMATION SHOULD BE VERIFIED PRIOR TO PURCHASE OR LEASE.

4851 LBJ Freeway 10th Floor
Dallas TX 75244
214 256 7100

nairl.com